

For continuation refer to drawing 4929-002-5002

DO NOT SCALE OFF THIS DRAWING

NOTES

1. The contractor is responsible for verifying all site & setting out dimensions before commencing work.
2. This drawing is to be read in conjunction with all relevant Architectural and M&E drawings.
3. All dimensions in meters unless stated otherwise.

Key:

- Site Boundary
- Adoptable Foul Water Manhole & Pipe
Refer to schedule for size types and cover details
- Adoptable Surface Water Manhole & Pipe
Refer to schedule for size types and cover details
- Adoptable Surface Water Road Gully
- Adoptable Deepbore Soakaways
5m from other Soakaways and 10m for building structures
See plan for depths
- Adoptable Surface Water Catchpit - 500mm Sump
- Adoptable Surface Water Headwall,
Aliphon PCC, Rootlok Geogrow, ACO Swale Inlet
(see details for types)
- Private / Management Company Foul Water PPIC & Pipe
Refer to schedule for size types and cover details
- Private / Management Company Surface Water PPIC & Pipe
Refer to schedule for size types and cover details
- Private / Management Company Aco Drainage Channel
- Private / Management Company Rodding Eye
- Private / Management Company Distribution Tank
- Private / Management Company Surface Water Road Gully
- Private / Management Company Permeable Paving
- Private / Management Company Fin Drain within Subbase
- Existing 150mm Foul Water Southern Water Sewer
- Existing Thames Water Rising Main

Note: Further falling head tests to be taken at the time of installation of the deep bore soakaways and at appropriate locations and depths. Calculations to be updated based on recorded results.

For continuation refer to drawing 4929-002-5004

For continuation refer to drawing 4929-002-5005

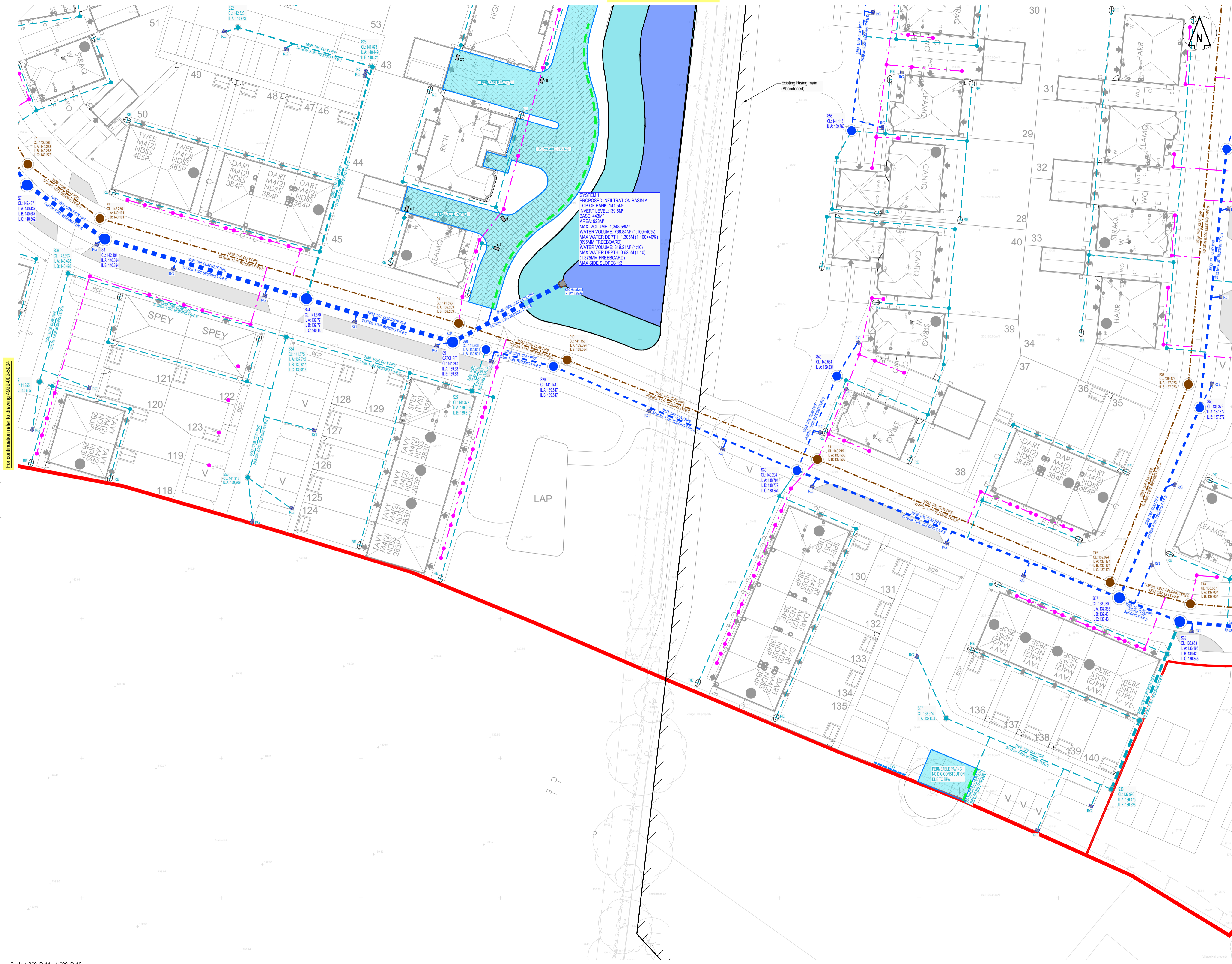

Revision History					
Rev	Comment	By	Chkd	Appr	Date
P03	ISSUED FOR INFORMATION	SK	SB	SB	07/08/2024
P02	ISSUED FOR INFORMATION	SK	SB	SB	06/03/2024
P01	ISSUED FOR INFORMATION	SK	SB	SB	20/06/2023
Current Revision					
P04	BASIN A AND B SIZE REVISED TO AVOID FOOTWAY. BASINS A,B & C WATER LEVELS UPDATED TO SUIT.	FR	SB	SB	14/08/2024

INFORMATION

REDROW HOMES LIMITED

Robert West
 1 Paris Garden
 London
 SE1 8ND
 t: 0203 773 7860
 www.robertwest.co.uk

Project
**LAND ADJACENT TO ROYSTON ROAD,
 BARKWAY**

Drawing Title
**PROPOSED DRAINAGE
 SHEET 5**

RWCL Internal Register reference: 4929-002 Scales @ A1
 5005 -P04

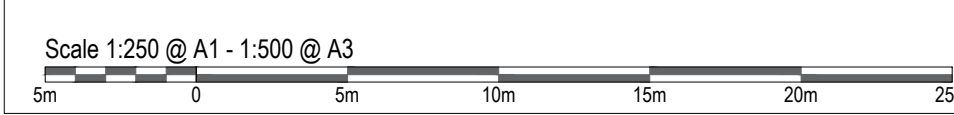

For continuation refer to drawing Inset A on drawing 5006