

NOTES

1. The contractor is responsible for verifying all site & setting out dimensions before commencing work.
2. This drawing is to be read in conjunction with all relevant Architectural and M&E drawings.
3. All dimensions in meters unless stated otherwise.

Key:

- Site Boundary
- Adoptable Foul Water Manhole & Pipe  
Refer to schedule for size types and cover details
- Adoptable Surface Water Manhole & Pipe  
Refer to schedule for size types and cover details
- Adoptable Surface Water Road Gully
- Adoptable Deepbore Soakaways  
5m from other Soakaways and 10m for building structures  
See plan for depths
- Adoptable Surface Water Catchpit - 500mm Sump
- Adoptable Surface Water Headwall  
Althron PCC, Rootlok Geogrow, ACO Swale Inlet  
(see details for types)
- Private / Management Company Foul Water PPIC & Pipe  
Refer to schedule for size types and cover details
- Private / Management Company Surface Water PPIC & Pipe  
Refer to schedule for size types and cover details
- Private / Management Company Aco Drainage Channel
- Private / Management Company Rodding Eye
- Private / Management Company Distribution Tank
- Private / Management Company Surface Water Road Gully
- Private / Management Company Permeable Paving
- Private / Management Company Fin Drain within Subbase
- Existing 150mmØ Foul Water Southern Water Sewer
- Existing Thames Water Rising Main

Note: Further falling head tests to be taken at the time of installation of the deep bore soakaways and at appropriate locations and depths. Calculations to be updated based on recorded results.

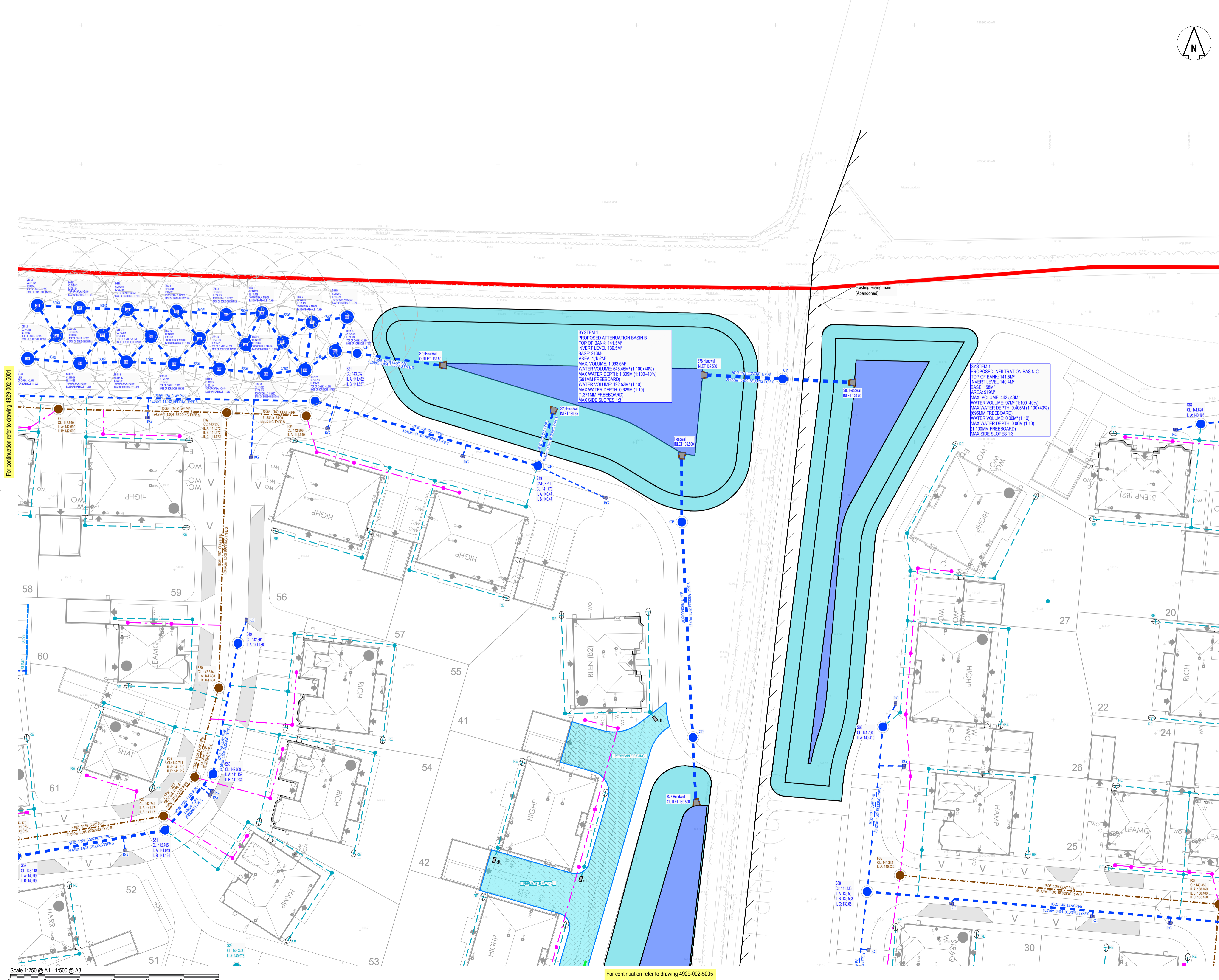

For continuation refer to drawing 4929-002-5001

For continuation refer to drawing 4929-002-5003

Revision History					
Rev	Comment	By	Chkd	Appr	Date
P03	ISSUED FOR INFORMATION	SK	SB	SB	07/08/2024
P02	ISSUED FOR INFORMATION	SK	SB	SB	06/03/2024
P01	ISSUED FOR INFORMATION	SK	SB	SB	20/06/2023
Current Revision					
P04	BASIN A AND B SIZE REVISED TO AVOID FOOTWAY. BASINS A,B & C WATER LEVELS UPDATED TO SUIT.	PR	SB	SB	14/08/2024

**INFORMATION**

**REDROW HOMES LIMITED**

**Robert West**

1 Paris Garden  
London  
SE1 8ND  
t: 0203 773 7860  
www.robertwest.co.uk

Project  
**LAND ADJACENT TO ROYSTON ROAD, BARKWAY**

Drawing Title  
**PROPOSED DRAINAGE SHEET 2**